

STATE OF NORTH CAROLINA
DIVISION OF HIGHWAYS

STATE	STATE PROJECT REFERENCE NO.	SHEET NO.	TOTAL SHEETS
N.C.	11C.099081	1	8

YADKIN COUNTY

**LOCATION: SR 1135 WRIGHT RD. FROM THE INTERSECTION
OF SR 1126 "PETTY RD. STA. 10+00 TO END OF PROJECT
STA. 41+63.12**

TYPE OF WORK: GRADE, DRAIN, BASE, PAVE - 0.60 MILES

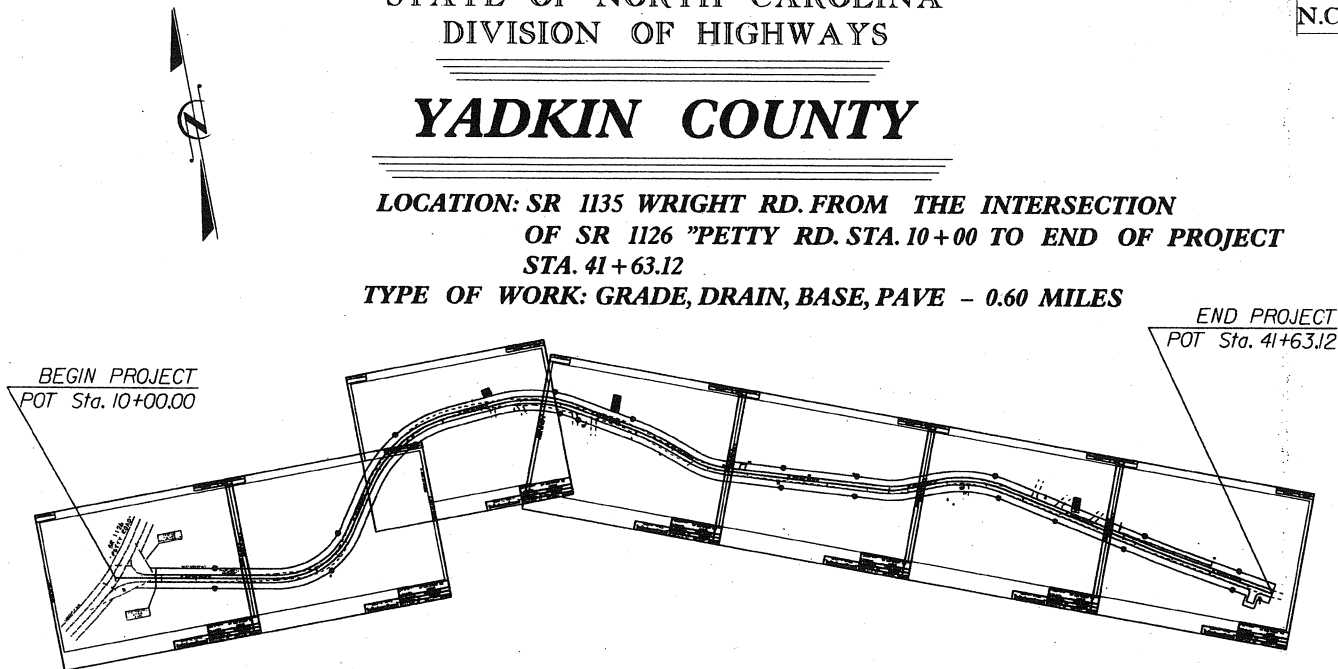

THESE EROSION AND SEDIMENT CONTROL PLANS COMPLY WITH THE REGULATIONS SET FORTH BY THE NCG1000 GENERAL CONSTRUCTION PERMIT EFFECTIVE AUGUST 3, 2011 ISSUED BY THE NORTH CAROLINA DEPARTMENT OF ENVIRONMENT AND NATURAL RESOURCES DIVISION OF WATER QUALITY

SITE DESCRIPTION	STABILIZATION	TIMEFRAME EXCEPTIONS
PERIMETER DIKES, SWALES, DITCHES AND SLOPES	7 DAYS	NONE
HIGH QUALITY WATER ZONES	7 DAYS	NONE
SLOPES STEEPER THAN 3:1	7 DAYS	IF SLOPES ARE 10' OR LESS IN LENGTH AND ARE NOT STEEPER THAN 2:1, 14 DAYS ARE ALLOWED
SLOPES 3:1 OR FLATTER	14 DAYS	7 DAYS FOR SLOPES GREATER THAN 20' IN LENGTH
ALL OTHER AREAS FLATTER THAN 4:1	14 DAYS	NONE, EXCEPT FOR PERIMETERS AND HQW ZONES

DISCLAIMER

THIS MAP IS NOT A CERTIFIED SURVEY AND HAS NOT BEEN REVIEWED BY A LOCAL GOVERNMENT AGENCY FOR COMPLIANCE WITH ANY APPLICABLE LAND DEVELOPMENT REGULATIONS. THE PROPERTY SHOWN ON THIS MAP WAS LOCATED FOR THE NORTH CAROLINA DEPARTMENT OF TRANSPORTATION FOR HIGHWAY DESIGN PURPOSES. SOME ERROR MAY EXIST BETWEEN THE GRAPHICAL AND ACTUAL GROUND LOCATIONS OF PROPERTY LINES. THIS MAP IS TO BE USED AS A GRAPHICAL REPRESENTATION OF THE NCDOT'S INTENT TO ACQUIRE PROPERTY FOR RIGHT OF WAY PURPOSES, AND IN NO WAY REPRESENTS AN ACTUAL BOUNDARY SURVEY OF THIS PROPERTY.

GRAPHIC SCALES

DESIGN DATA

PROJECT LENGTH

0.60 MILES

Prepared In the Office of:

DIVISION OF HIGHWAYS
DIVISION 11, DISTRICT 1, ELKIN
P.O. BOX 558 ELKIN, NC 28621

RIGHT OF WAY DATE:
MAY 28, 2009

LETTING DATE:

M.A. PETTYJOHN, P.E.
DIVISION ENGINEER

B.W. WHITAKER, P.E.
DISTRICT ENGINEER

DIVISION ENGINEER

SIGNATURE: _____ P.E.
DISTRICT ENGINEER

SIGNATURE: _____ P.E.

DIVISION OF HIGHWAYS
STATE OF NORTH CAROLINA

SIGNATURE: _____ P.E.
STATE DESIGN ENGINEER
DEPARTMENT OF TRANSPORTATION
FEDERAL HIGHWAY ADMINISTRATION

APPROVED
DIVISION ADMINISTRATOR DATE

18" MIN. WATTLE HEIGHT

ALL BASIN'S 10'-20'
IN LENGTH REQUIRE
2 COIR FIBER BAFFLES.
BASIN'S LESS THAN 10'
REQUIRE ONLY 1

DESIGN BY: J. C. BRYANT 669



BEGIN PROJECT
POT Sta. 10+00.00

SR 1126
"PETTY ROAD"

EXISTING
100' X 100'
SIGHT TRIANGLE

9 x 3 x 3
ID 2.B

2.0 %

PROPOSED 25' RW

S 78° 56' 54.4" F

PROPOSED 18'
PAVEMENT

EXISTING 50' RW

9 x 3 x 3
ID 2.A

EXISTING
TELEPHONE
PEDESTAL
STA. 10+21

PROPOSED
PIPE
15" X 20'
STA. 11+05

2.0 %

END EXISTING
50' RW
11+00

MATCHLINE SEE SHEET *

MATCHLINE SEE SHEET *3

LOCATION:	SR 1135 WRIGHT RD.
COUNTY:	YADKIN
TOWNSHIP:	DEEP CREEK
DESIGNED BY:	J.D.WOOD
CHECKED BY:	JCB DATE: 3/11/2012

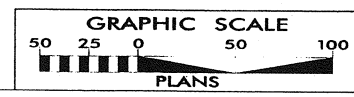

PI Sta 15+30.06
 $\Delta = 66^\circ 50' 55.4''$ (LT)
 $D = 28^\circ 38' 52.4''$
 $L = 233.35'$
 $T = 132.00'$
 $R = 200.00'$



MATCHLINE SEE SHEET #2

MATCHLINE SEE SHEET #4

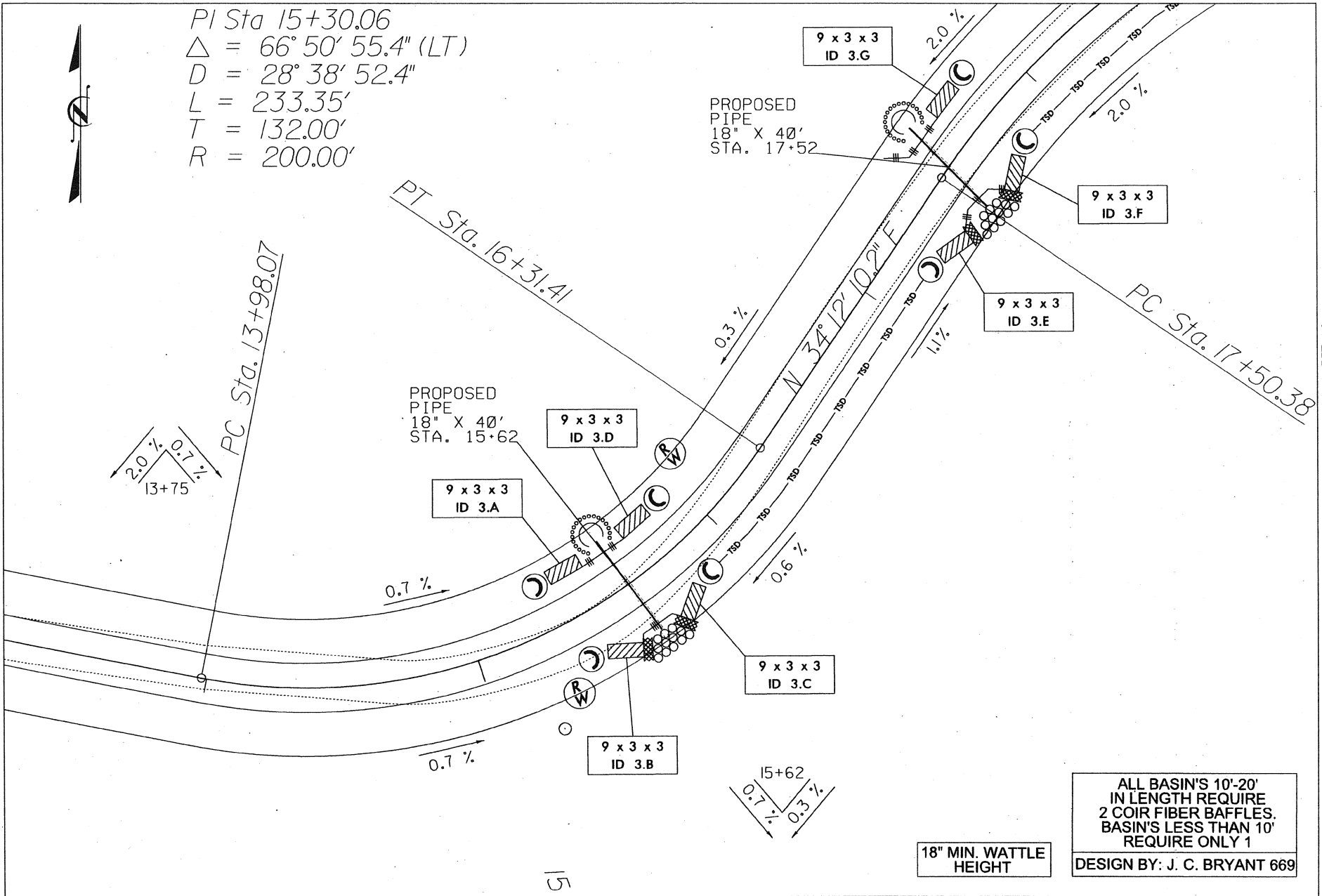

ALL BASIN'S 10'-20'
 IN LENGTH REQUIRE
 2 COIR FIBER BAFFLES.
 BASIN'S LESS THAN 10'
 REQUIRE ONLY 1
 DESIGN BY: J. C. BRYANT 669

18" MIN. WATTLE
 HEIGHT

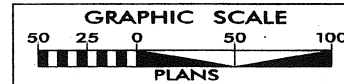

LOCATION:	SR 1135 WRIGHT RD.
COUNTY:	YADKIN
TOWNSHIP:	DEEP CREEK
DESIGNED BY:	J.D. WOOD
CHECKED BY:	JCB DATE: 3/1/2012

ALL BASIN'S 10'-20' IN LENGTH REQUIRE 2 COIR FIBER BAFFLES. BASIN'S LESS THAN 10' REQUIRE ONLY 1
 DESIGN BY: J. C. BRYANT 669

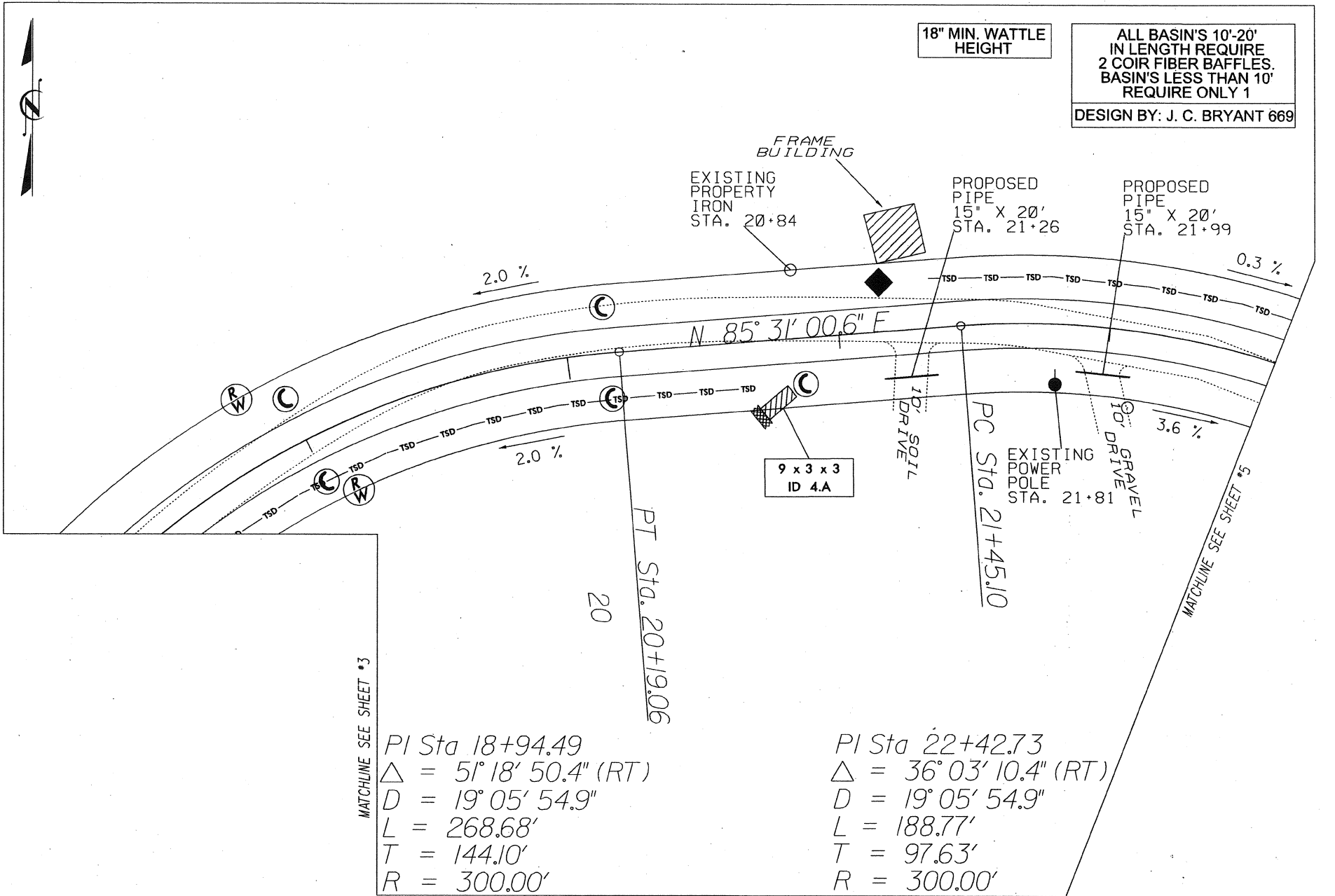

LOCATION: SR 1135 WRIGHT RD.
 COUNTY: YADKIN
 TOWNSHIP: DEEP CREEK
 DESIGNED BY: J.D.WOOD
 CHECKED BY: JCB DATE: 3/1/2012

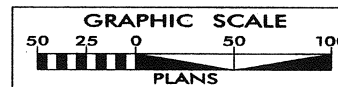

ALL BASIN'S 10'-20' IN LENGTH REQUIRE 2 COIR FIBER BAFFLES. BASIN'S LESS THAN 10' REQUIRE ONLY 1

DESIGN BY: J. C. BRYANT 669

18" MIN. WATTLE HEIGHT

9 x 3 x 3 ID 5.A

PROPOSED PIPE 15" X 20' STA. 23+41

9 x 3 x 3 ID 5.B

9 x 3 x 3 ID 5.D

9 x 3 x 3 ID 5.C

MATCHLINE SEE SHEET #4

MATCHLINE SEE SHEET #6

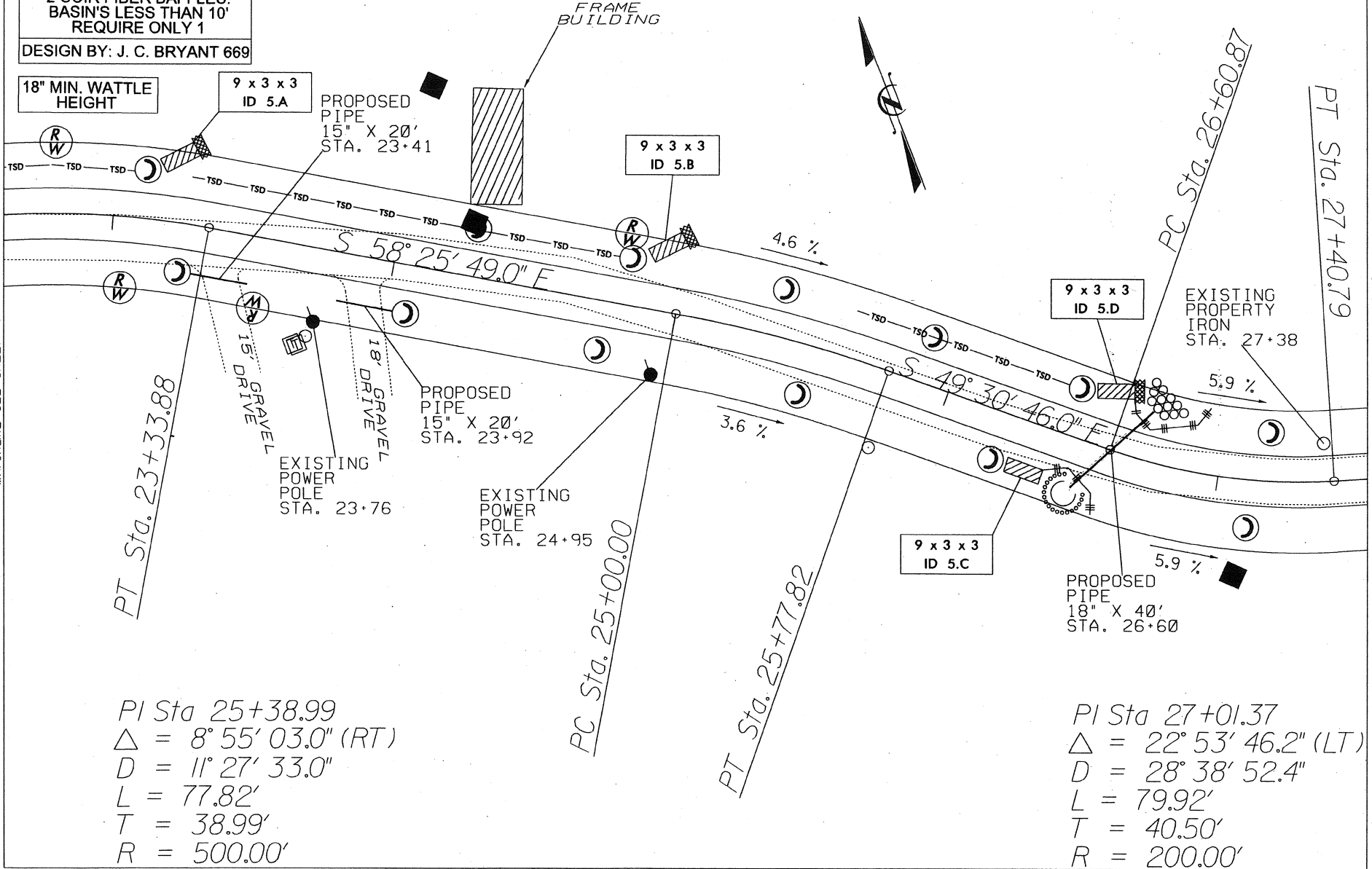

PI Sta 25+38.99
 $\Delta = 8^\circ 55' 03.0"$ (RT)
 $D = 11^\circ 27' 33.0"$
 $L = 77.82'$
 $T = 38.99'$
 $R = 500.00'$

PI Sta 27+01.37
 $\Delta = 22^\circ 53' 46.2"$ (LT)
 $D = 28^\circ 38' 52.4"$
 $L = 79.92'$
 $T = 40.50'$
 $R = 200.00'$

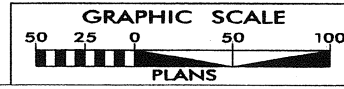

LOCATION:	SR 1135 WRIGHT RD.
COUNTY:	YADKIN
TOWNSHIP:	DEEP CREEK
DESIGNED BY:	J.D.WOOD
CHECKED BY:	JCB DATE: 3/1/2012

ALL BASIN'S 10'-20'
IN LENGTH REQUIRE
2 COIR FIBER BAFFLES.
BASIN'S LESS THAN 10'
REQUIRE ONLY 1
DESIGN BY: J. C. BRYANT 669

18" MIN. WATTLE
HEIGHT

MATCHLINE SEE SHEET #5

MATCHLINE SEE SHEET #7

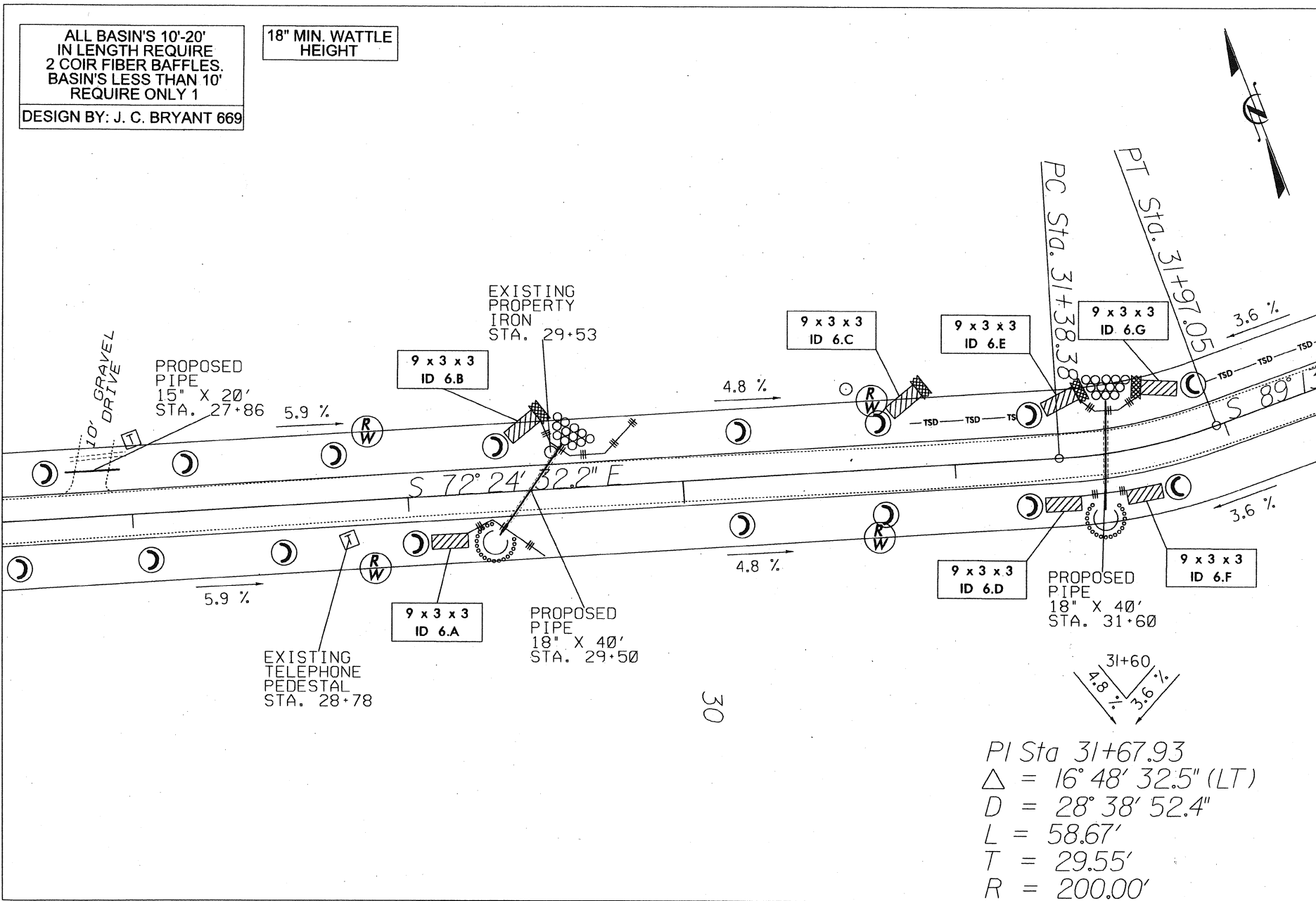

PI Sta 31+67.93
 $\Delta = 16^\circ 48' 32.5" (LT)$
 $D = 28^\circ 38' 52.4"$
 $L = 58.67'$
 $T = 29.55'$
 $R = 200.00'$

LOCATION:	SR 1135 WRIGHT RD.
COUNTY:	YADKIN
TOWNSHIP:	DEEP CREEK
DESIGNED BY:	J.D.WOOD
CHECKED BY:	JCB DATE: 3/1/2012

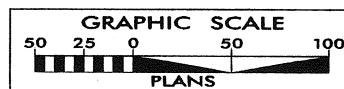

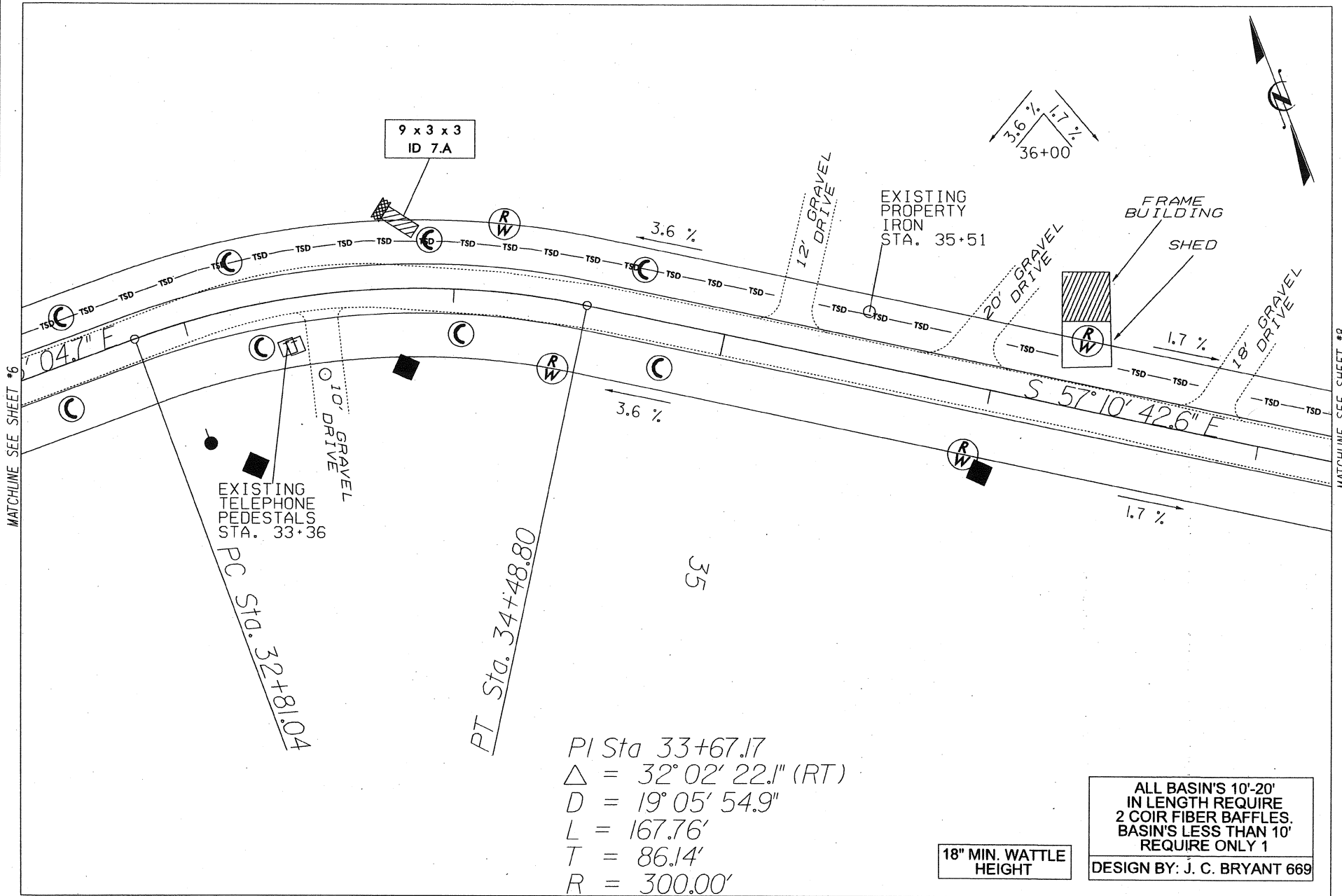

MATCHLINE SEE SHEET #6

MATCHLINE SEE SHEET #8

LOCATION: SR 1135 WRIGHT RD.
 COUNTY: YADKIN
 TOWNSHIP: DEEP CREEK
 DESIGNED BY: J.D.WOOD
 CHECKED BY: JCB DATE: 3/1/2012

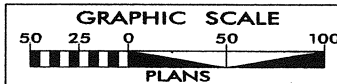

ALL BASIN'S 10'-20'
IN LENGTH REQUIRE
2 COIR FIBER BAFFLES.
BASIN'S LESS THAN 10'
REQUIRE ONLY 1

DESIGN BY: J. C. BRYANT 669

18" MIN. WATTLE
HEIGHT

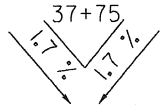

PC Sta. 38+49.75

PT Sta. 39+20.31



MATCHLINE SEE SHEET #7

9 x 3 x 3
ID 8.A

PROPOSED
PIPE
18" X 40'
STA. 37+67

9 x 3 x 3
ID 8.D

END PROJECT
POT Sta. 41+63.12

1.7 %

S 59° 25' 27.9" E

1.7 %

9 x 3 x 3
ID 8.B

9 x 3 x 3
ID 8.C

PI Sta 38+85.03
 $\Delta = 2^{\circ} 14' 45.3"$ (LT)
 $D = 3^{\circ} 10' 59.2"$
 $L = 70.56'$
 $T = 35.28'$
 $R = 1,800.00'$

40

RIGHT OF WAY
41+03
50.00 RT

RIGHT OF WAY
41+33
50.00 RT

EXISTING
TELEPHONE
PEDESTALS
STA. 41+37

LOCATION:	SR 1135 WRIGHT RD.
COUNTY:	YADKIN
TOWNSHIP:	DEEP CREEK
DESIGNED BY:	J.D.WOOD
CHECKED BY:	JCB DATE: 3/1/2012

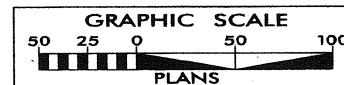

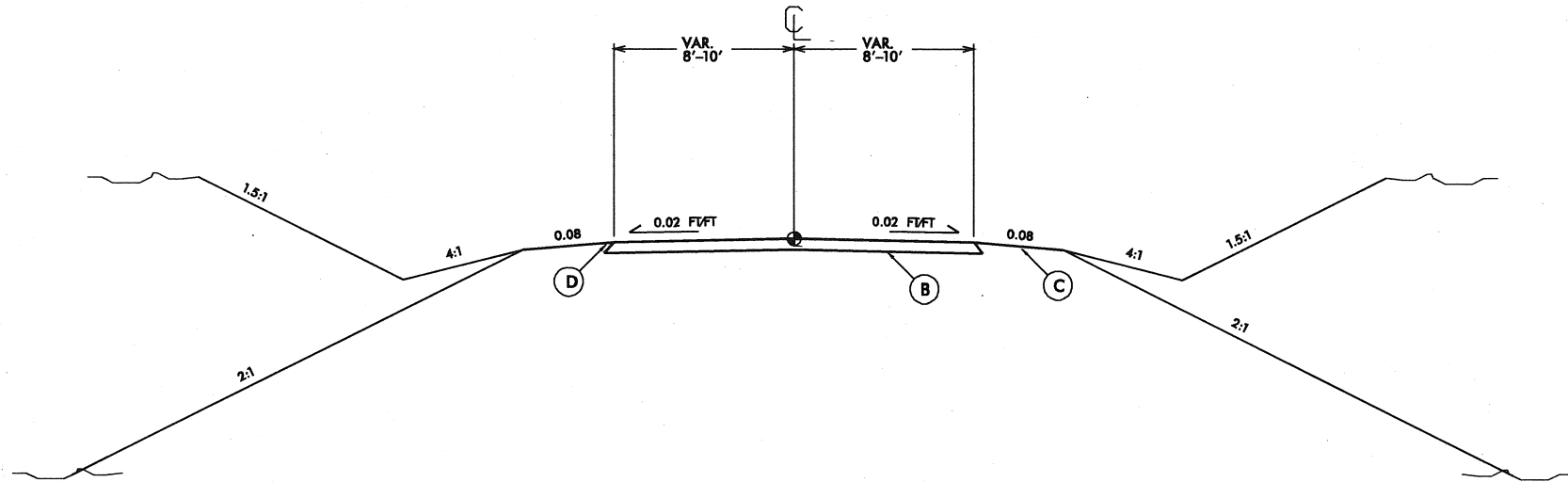

B 8" (compacted) ABC

C Shoulder varies: Cut side = 4' shoulder on .08 ft/ft
 transition to a 4:1 slope for a distance of 4'
 to center of the ditch line
 Fill side = 6' to shoulder break

D Base should be 1' wider than
 overall proposed road width

FENCE LINE DATA SHEET

ROAD NAME :SR 1135 "WRIGHT RD"

STATION	STATION	RT. / LT.	FUNC. / NONFUNC. FUNCTION	TYPE OF FENCE
37+45	40+00	LT.		5 STRAND ELECTRIC

Ditch Liner Requirements Rt -L-											
Construction Line (-L,-Y-,etc.)	2*3	3	3	3	3*4	4*5	5*6	6	6*7	7*8	8
Left or Right (LT.,RT.,Median)	R	R	R	R	R	R	R	R	R	R	R
Upper Station No.	1000	1375	1562	1650	1752	2230	2660	2950	3160	3600	3775
Upper Station Elevation (ft.)	999	1006.75	1005.5	1006	1004.9	1014.33	999	982	972	987.5	984.5
Lower Station No.	1375	1562	1650	1752	2230	2660	2950	3160	3600	3775	4163
Lower Station Elevation (ft.)	1006.75	1005.5	1006	1004.9	1014.33	999	982	972	987.5	984.5	991
Design Ditch Flow Depth (ft.)	0.33	0.33	0.33	0.33	0.33	0.33	0.33	0.33	0.33	0.33	0.33
Actual Ditch Depth (ft.)	1.8	1.8	1.8	1.8	1.8	1.8	1.8	1.8	1.8	1.8	1.8
Frontslope Grade (i.e. 2 for 2:1)	4	4	4	4	4	4	4	4	4	4	4
Backslope Grade (i.e. 2 for 2:1)	2	2	2	2	2	2	2	2	2	2	2
Base Width (ft., 0 for V-Ditches)	0	0	0	0	0	0	0	0	0	0	0
Measured Ditchline Length (ft.)	375	187	190	102	478	430	290	210	440	175	
Ditch Grade (%)	2.07	0.67	0.57	1.08	1.97	3.57	5.86	4.76	3.52	1.71	1.68
Velocity (ft/s)	2.7	1.53	1.41	1.95	2.63	3.54	4.54	4.09	3.52	2.45	2.43
Shear Stress in Ditch (lb/ft ²)	0.43	0.14	0.12	0.22	0.41	0.73	1.21	0.98	0.73	0.35	0.34
Ditch Liner Requirement	MATTING	None	None	None	MATTING	MATTING	PSRM	PSRM	MATTING	MATTING	MATTING
Matting Quantity (yd ²)	475	0	0	0	605	545	0	0	555	225	0
PSRM Matting Quantity (yd ²)	0	0	0	0	0	0	370	265	0	0	0

Ditch Liner Requirements Left -L-											
Construction Sheet #	2*3	3	3	3*4	4*5	5	5*6	6	6*7	7*8	8
Construction Line (-L,-Y-,etc.)	L	L	L	L	L	L	L	L	L	L	L
Left or Right (LT.,RT.,Median)	LT	LT	LT	LT	LT	LT	LT	LT	LT	LT	LT
Upper Station No.	1000	1375	1562	1752	2230	2330	2660	2950	3160	3600	3775
Upper Station Elevation (ft.)	999	1006.75	1005.5	1004.9	1014.33	1014	999	982	972	987.5	984.5
Lower Station No.	1375	1562	1752	2230	2330	2660	2950	3160	3600	3775	4163
Lower Station Elevation (ft.)	1006.75	1005.5	1004.9	1014.33	1014	999	982	972	987.5	984.5	991
Design Ditch Flow Depth (ft.)	0.33	0.33	0.33	0.33	0.33	0.33	0.33	0.33	0.33	0.33	0.33
Actual Ditch Depth (ft.)	1.8	1.8	1.8	1.8	1.8	1.8	1.8	1.8	1.8	1.8	1.8
Frontslope Grade (i.e. 2 for 2:1)	4	4	4	4	4	4	4	4	4	4	4
Backslope Grade (i.e. 2 for 2:1)	2	2	2	2	2	2	2	2	2	2	2
Base Width (ft., 0 for V-Ditches)	0	0	0	0	0	0	0	0	0	0	0
Measured Ditchline Length (ft.)	375	187	190	478	100	330	290	210	440	175	388
Ditch Grade (%)	2.07	0.67	0.32	1.97	0.33	4.55	5.86	4.76	3.52	1.71	1.68
Velocity (ft/s)	2.7	1.53	1.05	2.63	1.08	4	4.54	4.09	3.52	2.45	2.43
Shear Stress in Ditch (lb/ft2)	0.43	0.14	0.07	0.41	0.07	0.94	1.21	0.98	0.73	0.35	0.34
Ditch Liner Requirement	MATTING	None	None	MATTING	None	PSRM	PSRM	PSRM	MATTING	MATTING	MATTING
Matting Quantity (yd2)	475	0	0	605	0	0	0	0	555	225	490
PSRM Matting Quantity (yd2)	0	0	0	0	0	420	370	265	0	0	0